



Donaldson
FILTRATION SOLUTIONS

TECHNICAL DATASHEET

DFPRE Dust Collectors

Series DFPRE 4L - 6L

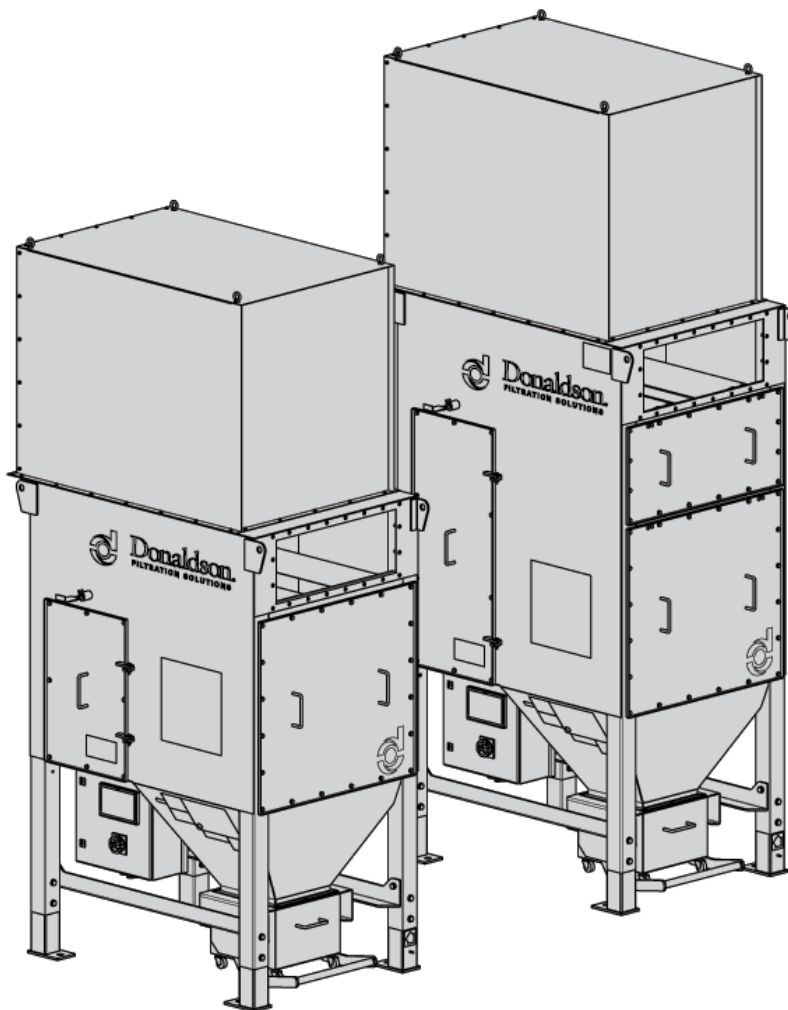

DESIGN SPECIFICATIONS

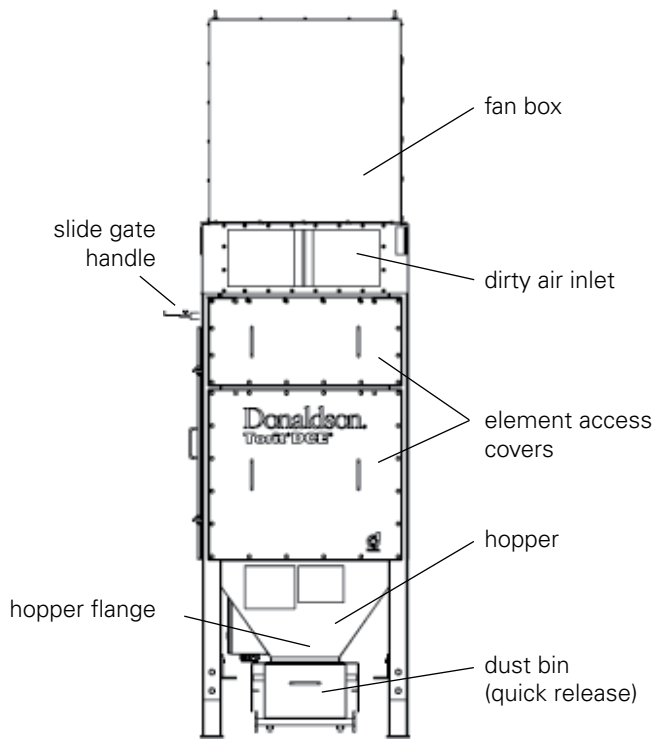

FRONT VIEW

6L shown with hook-on dustbin

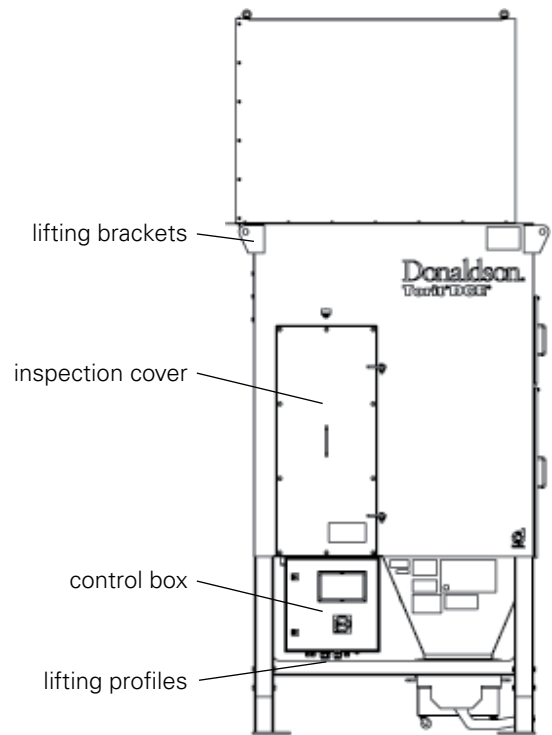

SIDE VIEW

6L shown with hook-on dustbin

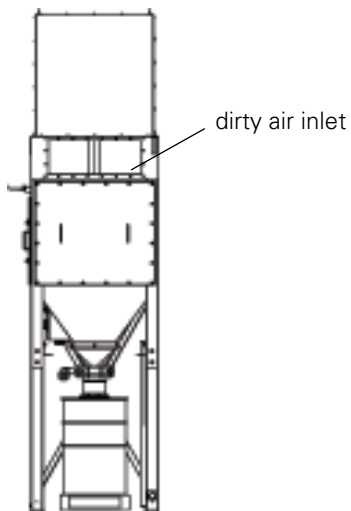

STANDARD

4L shown with 200 L drum

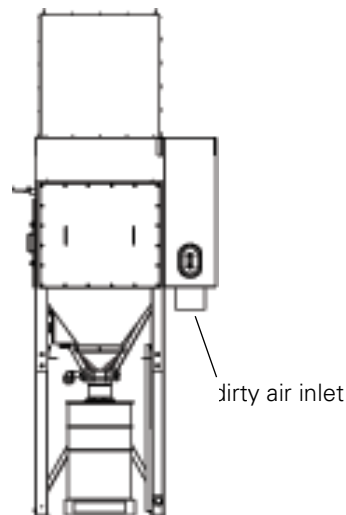

SPARKTRAP

4L shown with 200 L drum

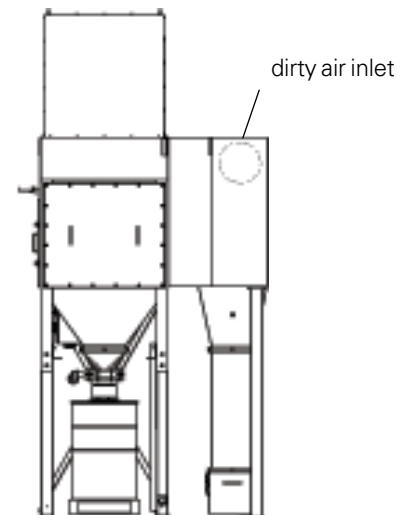

CYCLOPEEL

4L shown with 200 L drum

DESIGN LIMITS

Operating temperature: -10° to +40°C

Maximum operating pressure: -5 kPa (500 mm WG)*

Wind load rating: 160 km/h

Finishing: Acrylated alkyd paint colour RAL 5019 (blue) - semi gloss

* for use in positive pressure contact engineering

DIMENSIONS & SPECIFICATIONS 4L STANDARD



DFPRE 4L STANDARD

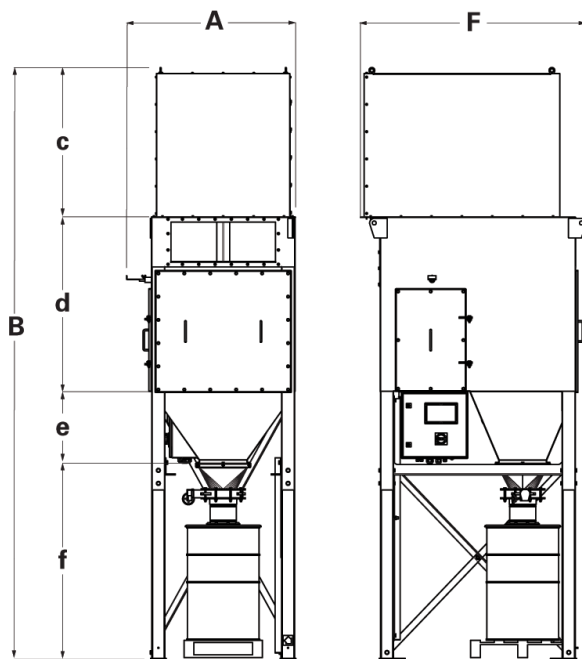

ROOF MOUNTED FAN

shown with 200 L drum

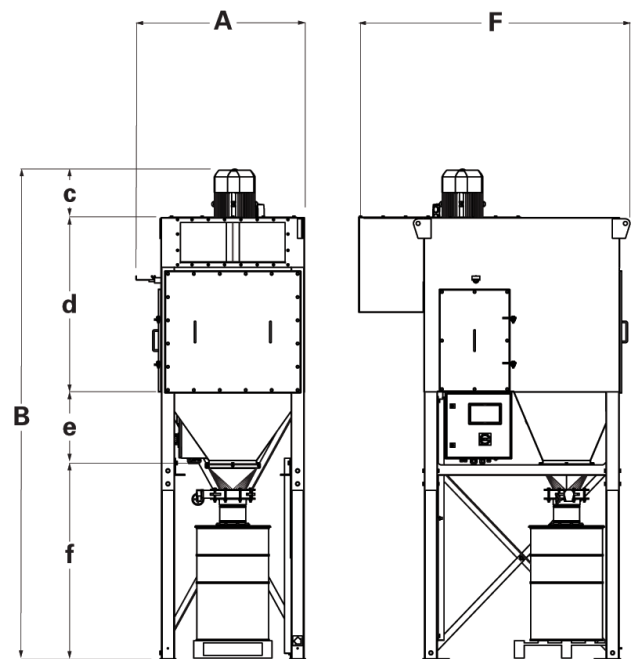

PARTIALLY INTEGRATED FAN

shown with 200 L drum

Model	No. of cartridges	No. of valves	Fan	Dust disposal system	Dimensions (mm)						
					A	B	c	d	e	f	F
DFPRE 4L	4	4	Roof mounted	200 L drum	1291	4537	1142	1347	548	1500	1730
				85 L drum	1291	4102	1142	1347	548	1065	1730
				hook-on dustbin	1291	3437	1142	1347	548	400	1730
				quick release	1291	3437	1142	1347	548	400	1730
			Partially integrated	200 L drum	1291	3732	337	1347	548	1500	2079
				85 L drum	1291	3297	337	1347	548	1065	2079
				hook-on dustbin	1291	2632	337	1347	548	400	2079
				quick release	1291	2632	337	1347	548	400	2079

DIMENSIONS & SPECIFICATIONS 4L SPARKTRAP



DFPRE 4L SPARKTRAP

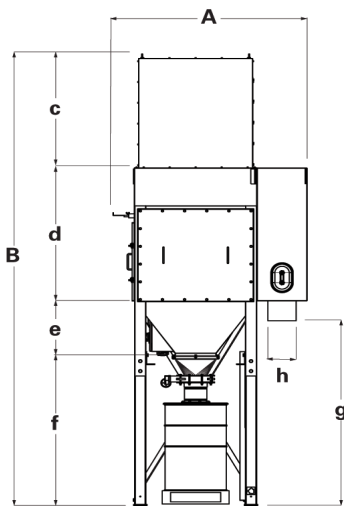

ROOF MOUNTED FAN

shown with 200 L drum

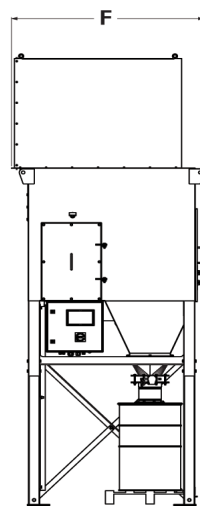

PARTIALLY INTEGRATED FAN

shown with 200 L drum

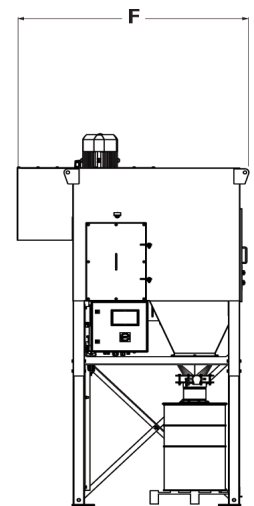
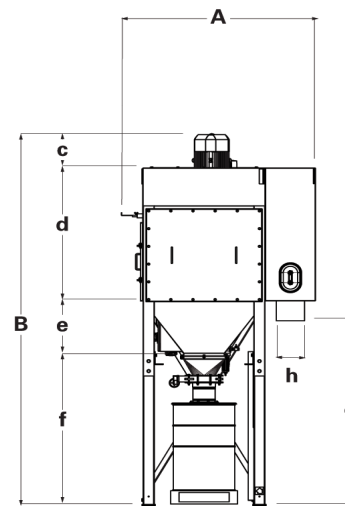

Model	No. of cartridges	No. of valves	Fan	Dust disposal system	Dimensions (mm)								
					A	B	c	d	e	f	g	h	F
DFPRE 4L Sparktrap	4	4	Roof mounted	200 L drum	1741	4537	1142	1347	548	1500	1855	242	1730
				85 L drum	1741	4102	1142	1347	548	1065	1420	242	1730
				hook-on dustbin	1741	3437	1142	1347	548	400	755	242	1730
				quick release	1741	3437	1142	1347	548	400	755	242	1730
			Partially integrated	200 L drum	1741	3732	337	1347	548	1500	1855	242	2079
				85 L drum	1741	3297	337	1347	548	1065	1420	242	2079
				hook-on dustbin	1741	2632	337	1347	548	400	755	242	2079
				quick release	1741	2632	337	1347	548	400	755	242	2079

DIMENSIONS & SPECIFICATIONS 4L CYCLOPEEL

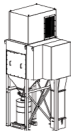

DFPRE 4L CYCLOPEEL

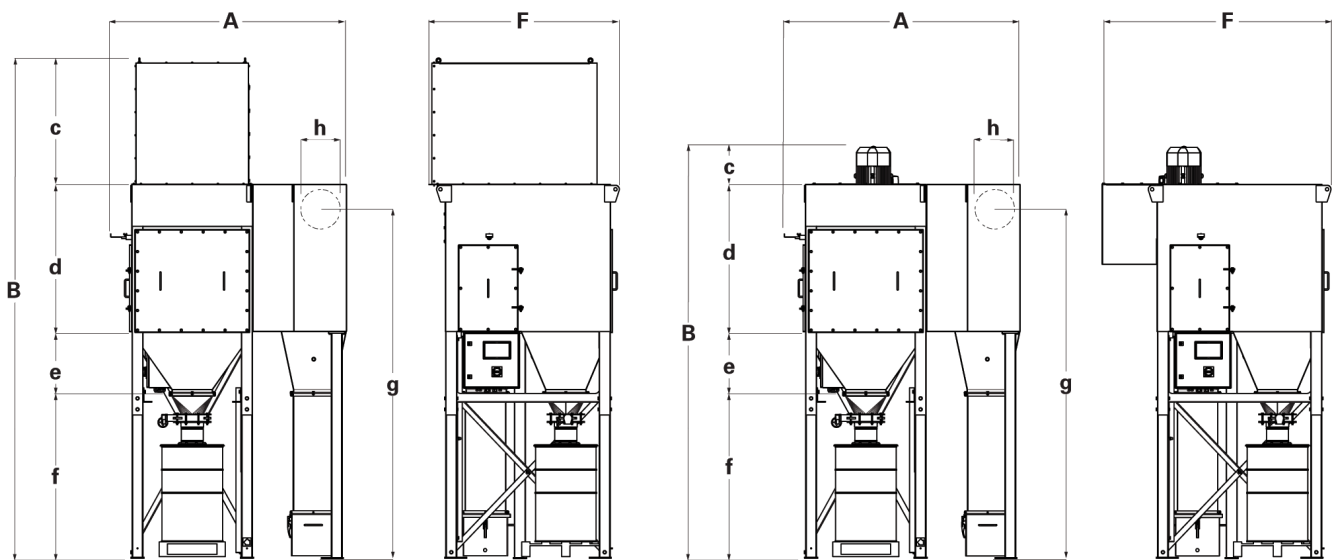

ROOF MOUNTED FAN

shown with 200 L drum

PARTIALLY INTEGRATED FAN

shown with 200 L drum

Model	No. of cartridges	No. of valves	Fan	Dust disposal system	Dimensions (mm)								
					A	B	c	d	e	f	g	h	F
DFPRE 4L Cyclopeel	4	4	Roof mounted	200 L drum	2143	4537	1142	1347	548	1500	3167	NW350	1730
				85 L drum	2143	4102	1142	1347	548	1065	2732	NW350	1730
				hook-on dustbin	2143	3437	1142	1347	548	400	2067	NW350	1730
				quick release	2143	3437	1142	1347	548	400	2067	NW350	1730
			Partially integrated	200 L drum	2143	3732	337	1347	548	1500	3167	NW350	2079
				85 L drum	2143	3297	337	1347	548	1065	2732	NW350	2079
				hook-on dustbin	2143	2632	337	1347	548	400	2067	NW350	2079
				quick release	2143	2632	337	1347	548	400	2067	NW350	2079

DIMENSIONS & SPECIFICATIONS 6L STANDARD

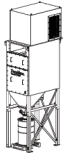

DFPRE 6L STANDARD

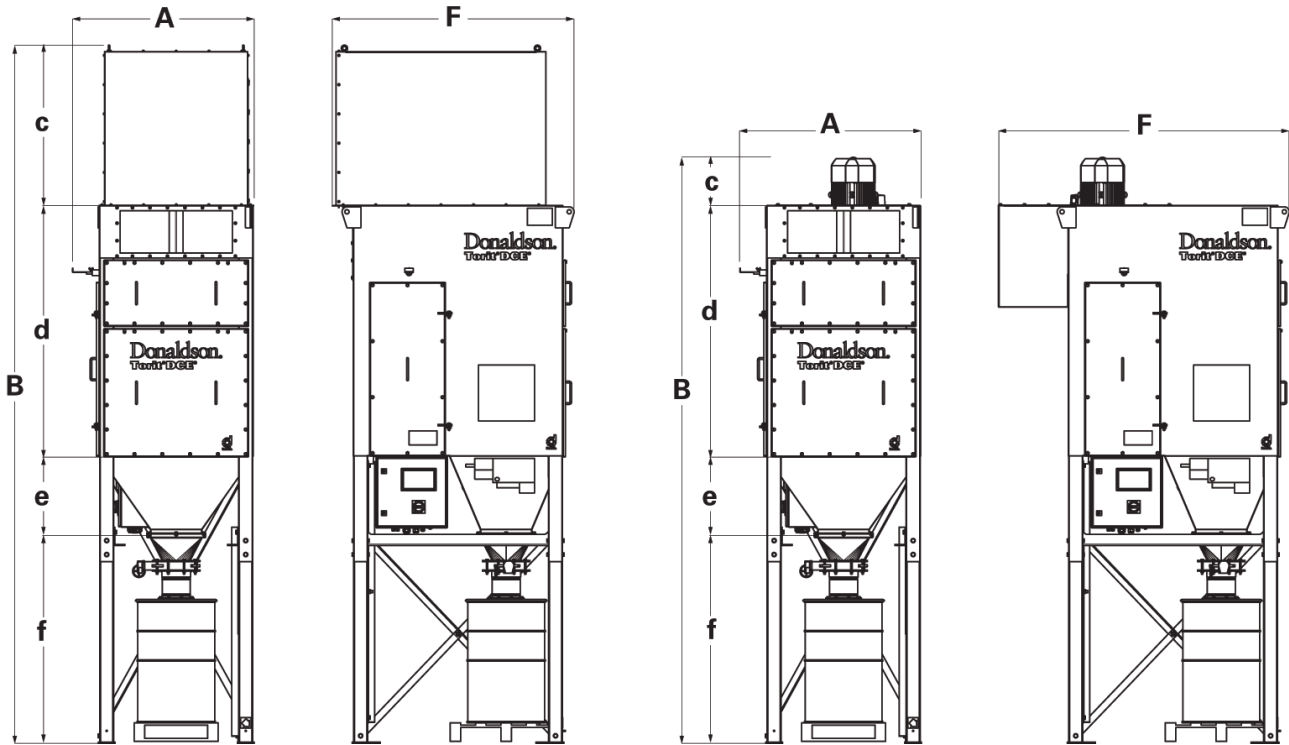

ROOF MOUNTED FAN

shown with 200 L drum

PARTIALLY INTEGRATED FAN

shown with 200 L drum

Model	No. of cartridges	No. of valves	Fan	Dust disposal system	Dimensions (mm)						
					A	B	c	d	e	f	F
DFPRE 6L Standard	6	6	Roof mounted	200 L drum	1291	4987	1142	1797	548	1500	1730
				85 L drum	1291	4552	1142	1797	548	1065	1730
				hook-on dustbin	1291	3887	1142	1797	548	400	1730
				quick release	1291	3887	1142	1797	548	400	1730
			Partially integrated	200 L drum	1291	4182	337	1797	548	1500	2079
				85 L drum	1291	3747	337	1797	548	1065	2079
				hook-on dustbin	1291	3082	337	1797	548	400	2079
				quick release	1291	3082	337	1797	548	400	2079

DIMENSIONS & SPECIFICATIONS 6L SPARKTRAP



DFPRE 6L SPARKTRAP

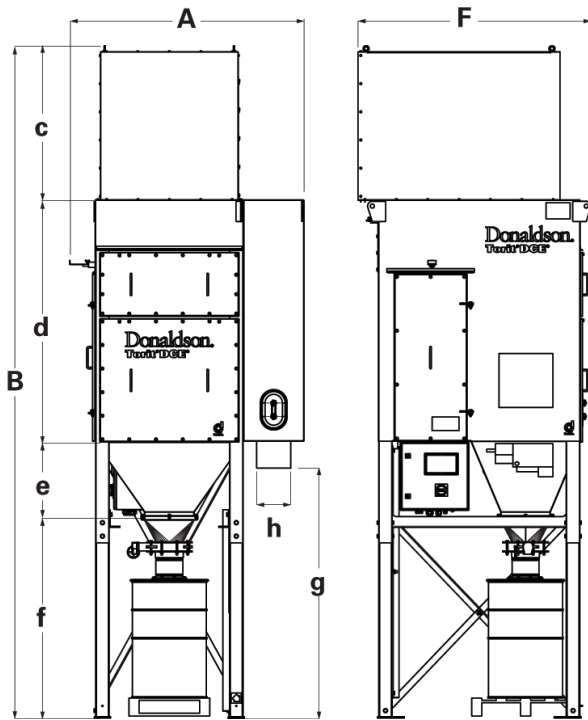

ROOF MOUNTED FAN

shown with 200 L drum

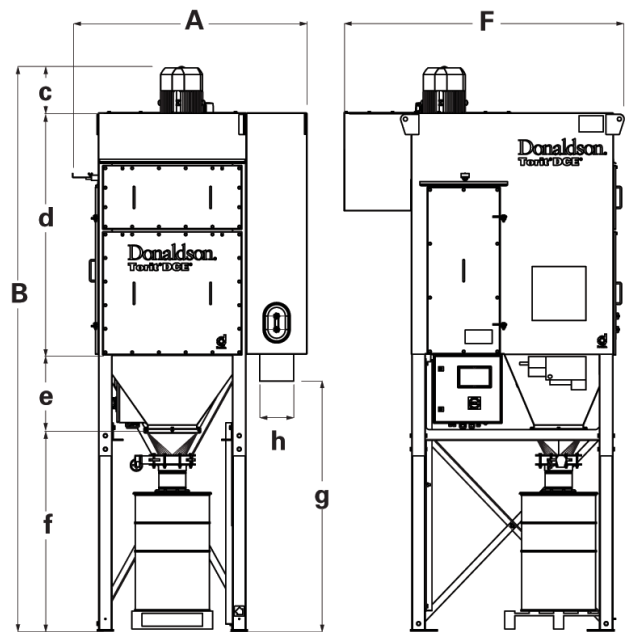

PARTIALLY INTEGRATED FAN

shown with 200 L drum

Model	No. of cartridges	No. of valves	Fan	Dust disposal system	Dimensions (mm)								
					A	B	c	d	e	f	g	h	F
DFPRE 6L Sparktrap	6	6	Roof mounted	200 L drum	1771	4987	1142	1797	548	1500	1855	247	1730
				85 L drum	1771	4552	1142	1797	548	1065	1420	247	1730
				hook-on dustbin	1771	3887	1142	1797	548	400	755	247	1730
				quick release	1771	3887	1142	1797	548	400	755	247	1730
			Partially integrated	200 L drum	1771	4182	337	1797	548	1500	1855	247	2079
				85 L drum	1771	3747	337	1797	548	1065	1420	247	2079
				hook-on dustbin	1771	3082	337	1797	548	400	755	247	2079
				quick release	1771	3082	337	1797	548	400	755	247	2079

DIMENSIONS & SPECIFICATIONS 6L CYCLOPEEL

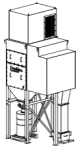

DFPRE 6L CYCLOPEEL

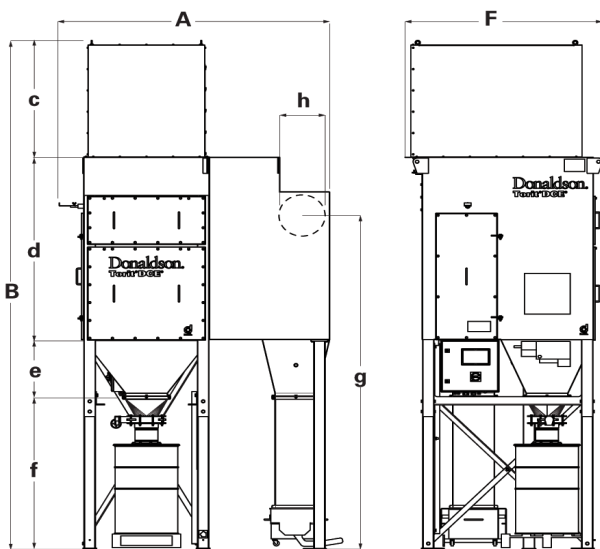

ROOF MOUNTED FAN

shown with 200 L drum

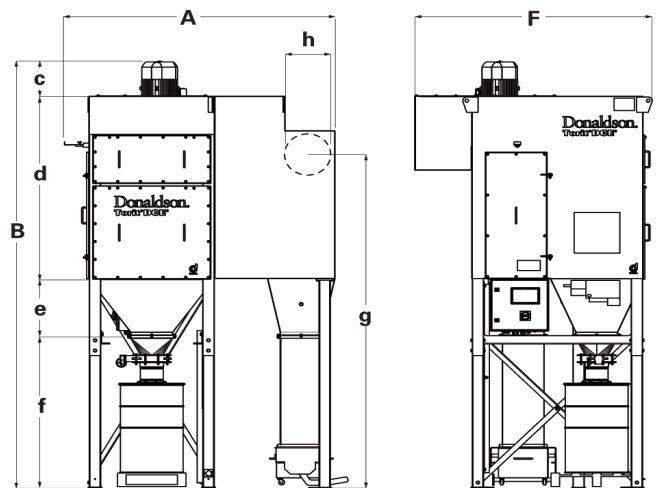

PARTIALLY INTEGRATED FAN

shown with 200 L drum

Model	No. of cartridges	No. of valves	Fan	Dust disposal system	Dimensions (mm)								
					A	B	c	d	e	f	g	h	F
DFPRE 6L Cyclopeel	6	6	Roof mounted	200 L drum	2351	4987	1142	1797	548	1500	3259	NW400	1730
				85 L drum	2351	4552	1142	1797	548	1065	2824	NW400	1730
				hook-on dustbin	2351	3887	1142	1797	548	400	2159	NW400	1730
				quick release	2351	3887	1142	1797	548	400	2159	NW400	1730
			Partially integrated	200 L drum	2351	4182	337	1797	548	1500	3259	NW400	2079
				85 L drum	2351	3747	337	1797	548	1065	2824	NW400	2079
				hook-on dustbin	2351	3082	337	1797	548	400	2159	NW400	2079
				quick release	2351	3082	337	1797	548	400	2159	NW400	2079

COLLECTOR WEIGHTS

Model	Type	Weight (in kg)
DFPRE 4L	Standard	1025
	Sparktrap	1143
	Cyclopeel	1306
DFPRE 6L	Standard	1143
	Sparktrap	1337
	Cyclopeel	1465

Weights include filter cartridges and are for collectors prior to first use, i.e. with no dust collected.

Excludes shipped loose items like fan set, fan box, legs and dust disposal system.

FAN SETS

Fan type	Power (in kW)	Frequency	Weight (in kg)
VCM 403S	2.2	50	41
VCM 451S	3	50	70
ART 452	4	50	98
ART 451	5.5	60	110
MEC 451	7.5	60	159
ART 502	7.5	60	151
ART 501	11	50	208
MEC 502	11	60	239

Fan type	Power (in kW)	Frequency	Weight (in kg)
ART 562	11	50	230
FP 501	11	50	251
ART 561	15	50	250
FQ 562	15	50	310
FQ 561	18.5	50	304
FR 501	18.5	50	207
ART 632	22	50	346

FAN PERFORMANCE CURVES

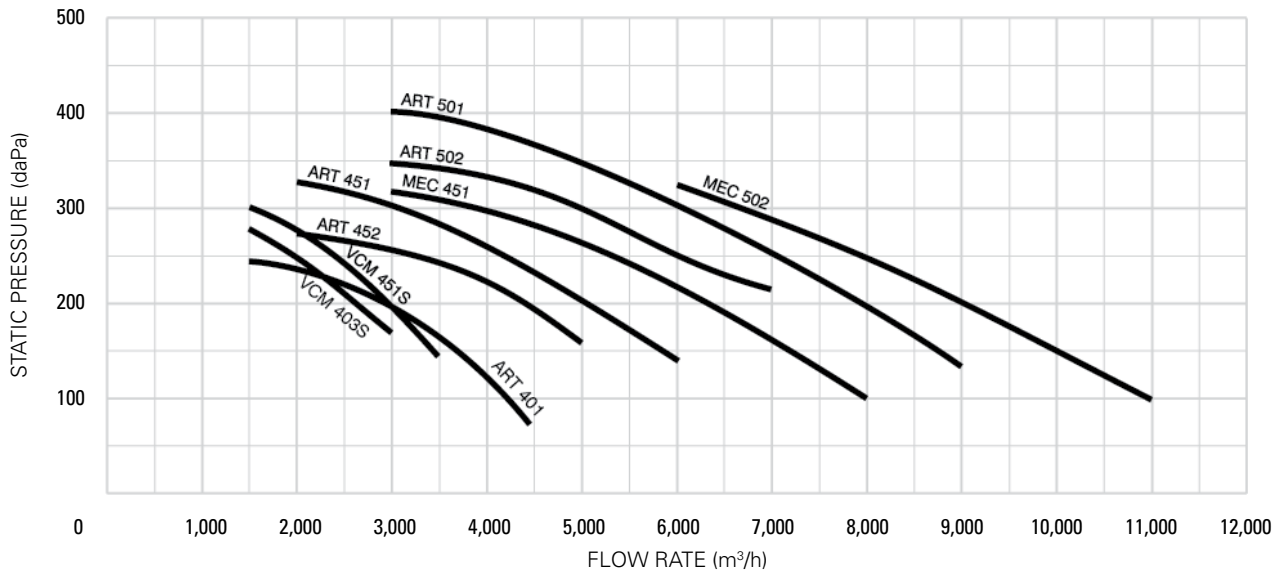

FAN PERFORMANCE CURVES (2.2 to 11 kW)

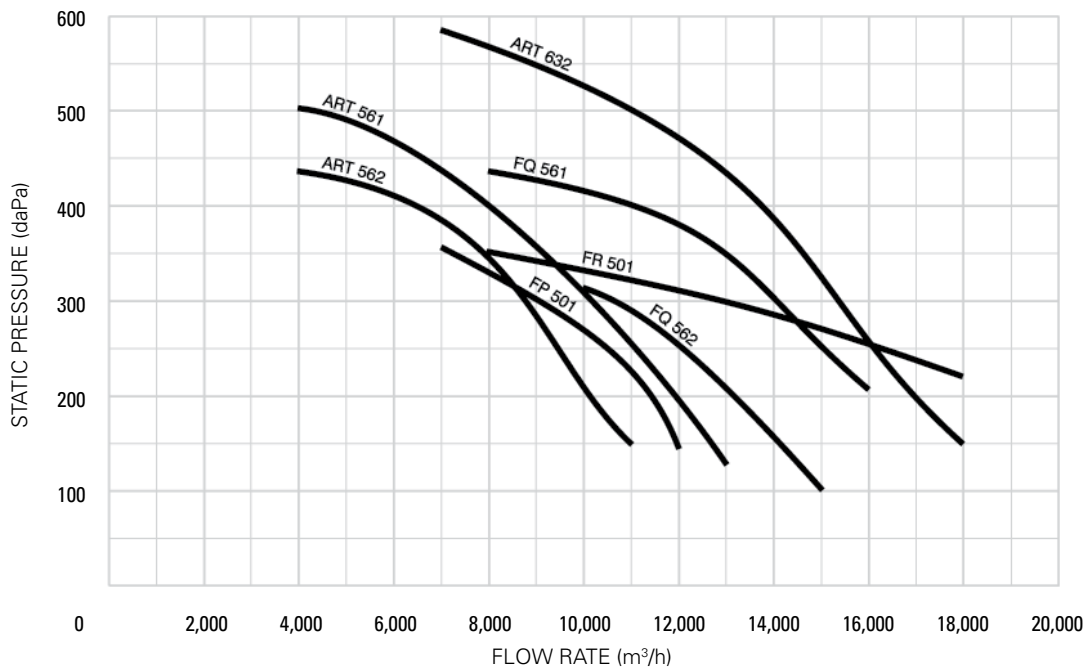

FAN PERFORMANCE CURVES (11 TO 22 KW)

FAN SELECTION

These curves indicate static pressure available at fan inlet for a given application, when fitted into a collector.

To select the most suitable fan for a given application:

- 1 Determine the air volume, in m³/h, needed to entrain the dust.
- 2 Estimate pressure drop through connected system – i.e. between point of entrainment and collector inlet.
- 3 Assess pressure drop over dust collector, prior to replacing filter cartridges, usually 100 daPa.
- 4 The sum of **2** and **3** = static pressure at inlet.
- 5 Consult graph for fan performance available.

DUST DISPOSAL OPTIONS

QUICK RELEASE DUST BIN

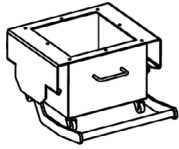

HOOK ON DUST BIN



85 L DRUM



200 L DRUM

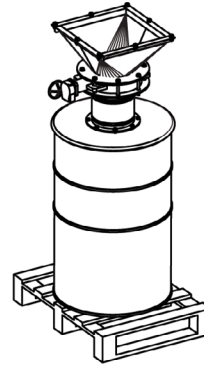

BIG BAG

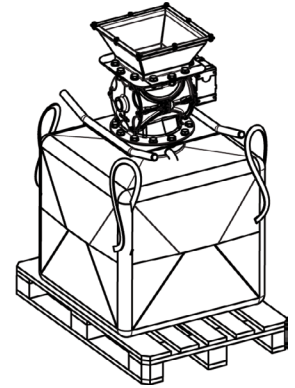

Dust disposal options	Hopper clearance (in mm)	Approx. weight (in kg)
quick release dust bin	400	40
hook-on dust bin	400	22
85 L drum	1065	15
200 L drum	1500	40
Big-bag (excluding bag and rotary airlock)	1800	18

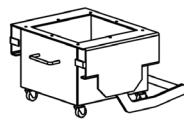
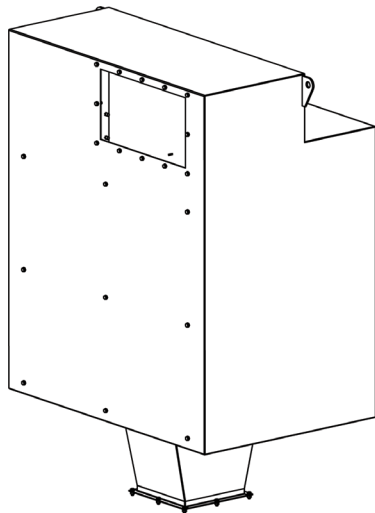

HOOK ON DUST BIN

QUICK RELEASE DUST BIN

Dust disposal options Cyclopeel	Hopper clearance (in mm)
quick release dust bin	400
hook-on dust bin	400
hook-on dust bin with caster	565

INLET OPTIONS - AVAILABLE SIZES

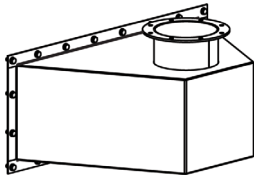

Abrasive resistant inlet box

NW200
NW250
NW315
NW400

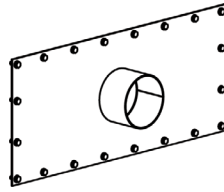

Inlet transition piece to spigot

ID154
ID195
ID245
ID275

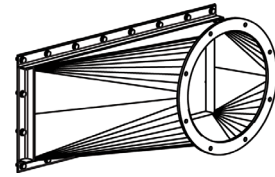

Front inlet transition piece

NW160
NW200
NW250
NW280
NW315
NW355
NW400
NW450
NW500

OUTLET OPTIONS

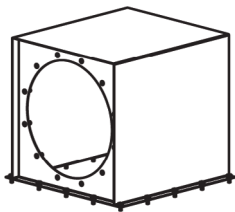

Outletbox NW500



Outletbox deflector

HEPA OPTION

Roof mounted fanbox with HEPA

up to 4 HEPA filters, each capable to handle 4000 CMH

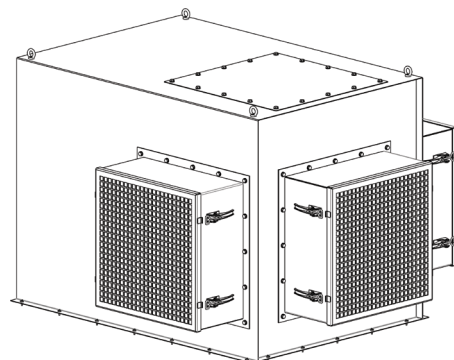

FOUNDATION DETAILS - 4L 6L - STANDARD - ROOF MOUNTED FAN

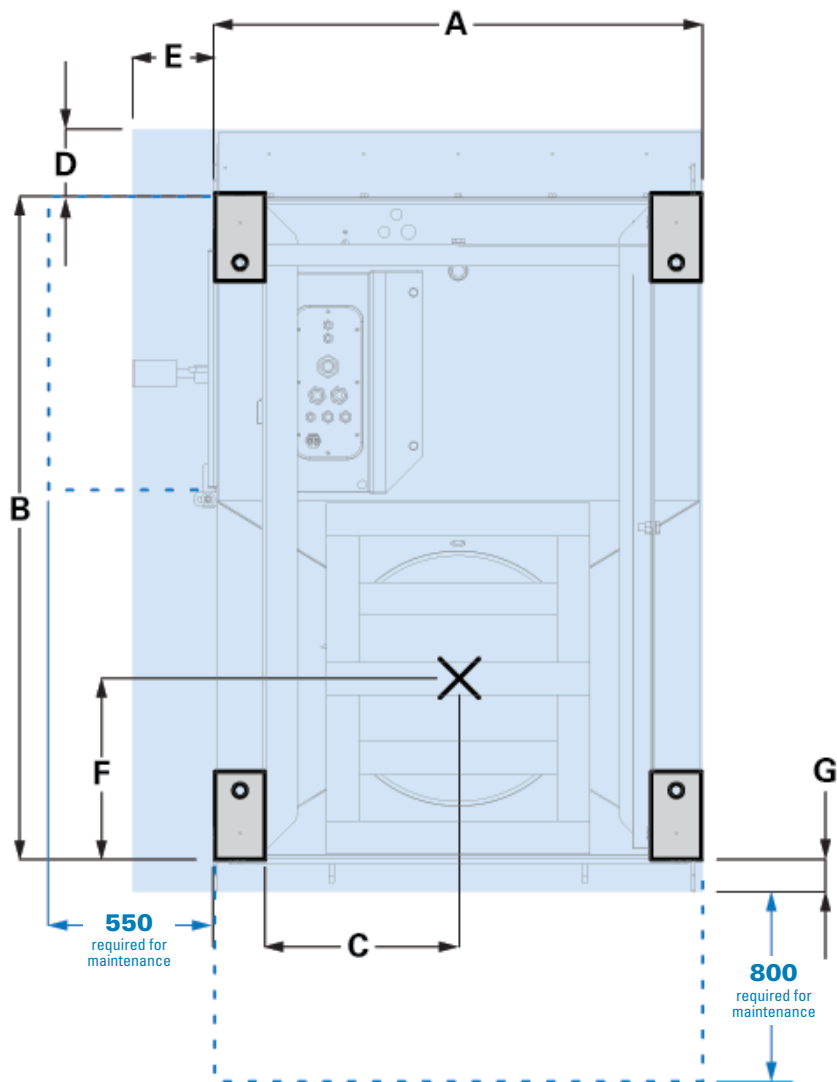
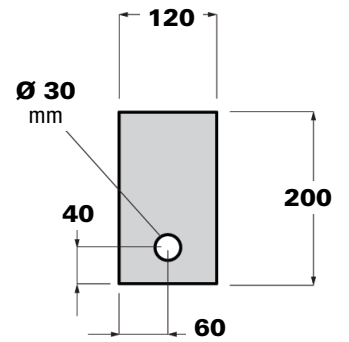
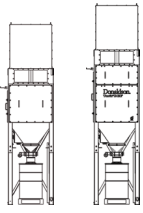

4L- 6L - Standard - Roof mounted fan dimensions (in mm)						
A	B	C	D	E	F	G
1114	1513	437	143.5	58	412.8	73

FOUNDATION DETAILS - 4L 6L - STANDARD - PARTIALLY INTEGRATED FAN

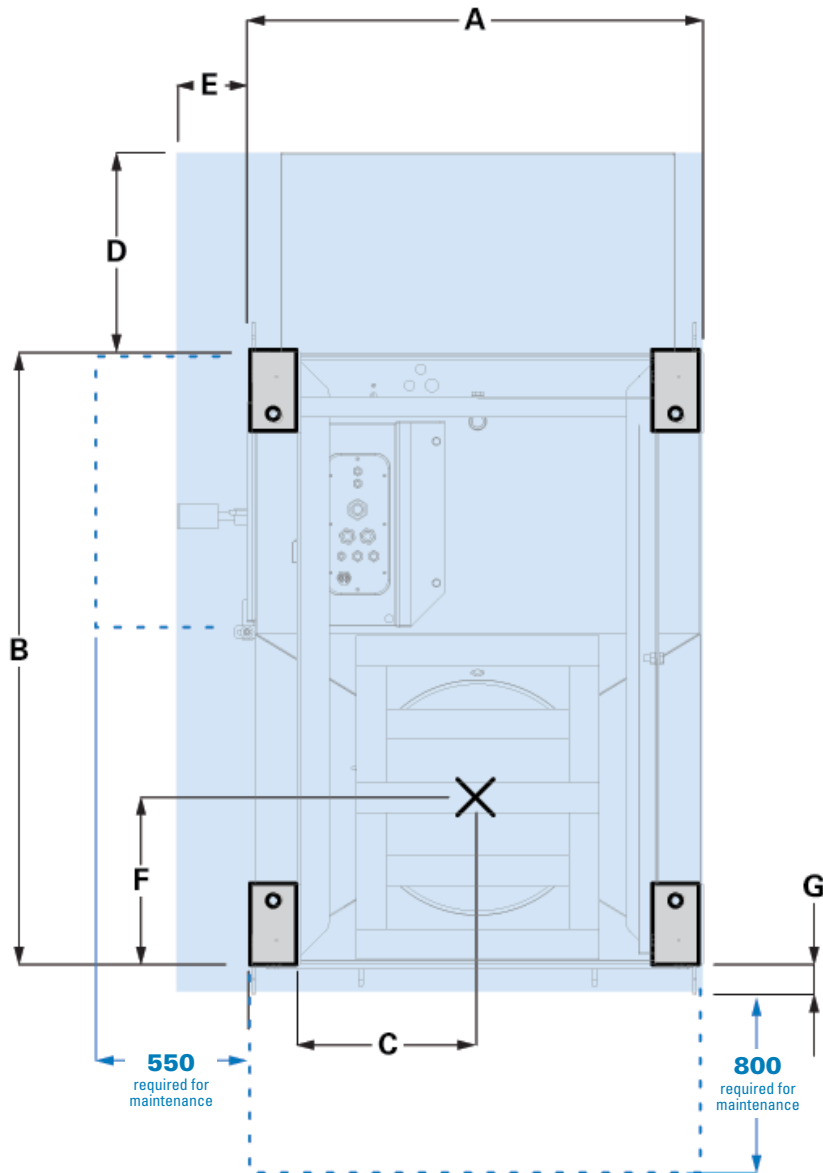
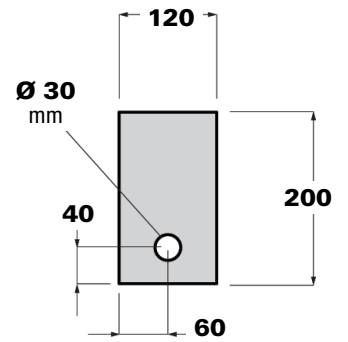
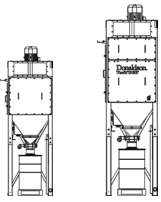

4L- 6L - Standard - Partially integrated fan dimensions (in mm)						
A	B	C	D	E	F	G
1114	1513	437	493	58	412.8	73

FOUNDATION DETAILS - 4L - SPARKTRAP - ROOF MOUNTED FAN

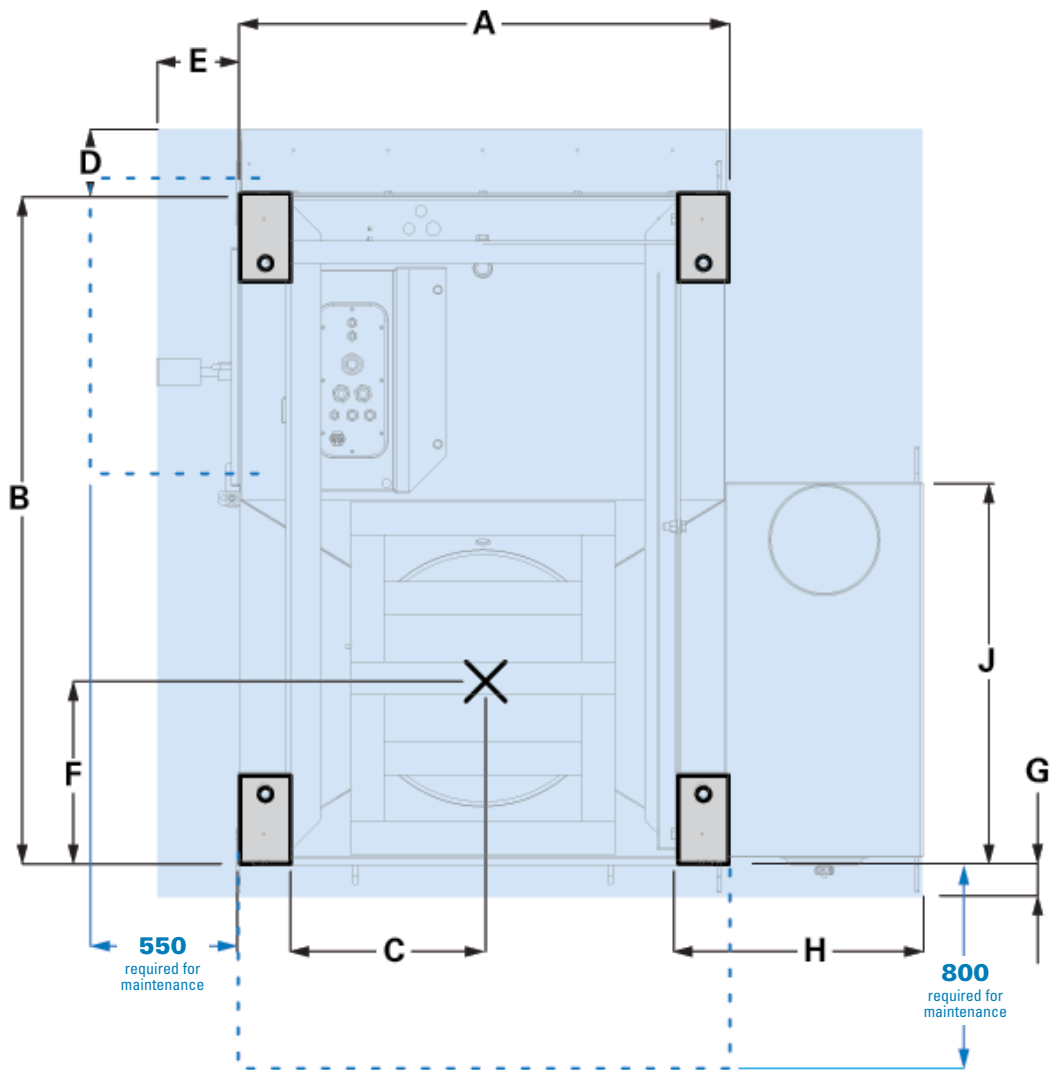
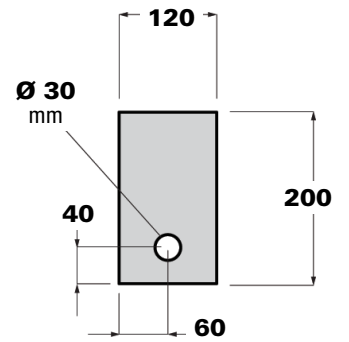
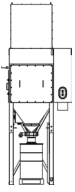

4L - Sparktrap - Roof mounted fan dimensions (in mm)								
A	B	C	D	E	F	G	H	J
1114	1513	437	143.5	58	412.8	73	443	844

FOUNDATION DETAILS - 4L - SPARKTRAP - PARTIALLY INTEGRATED FAN

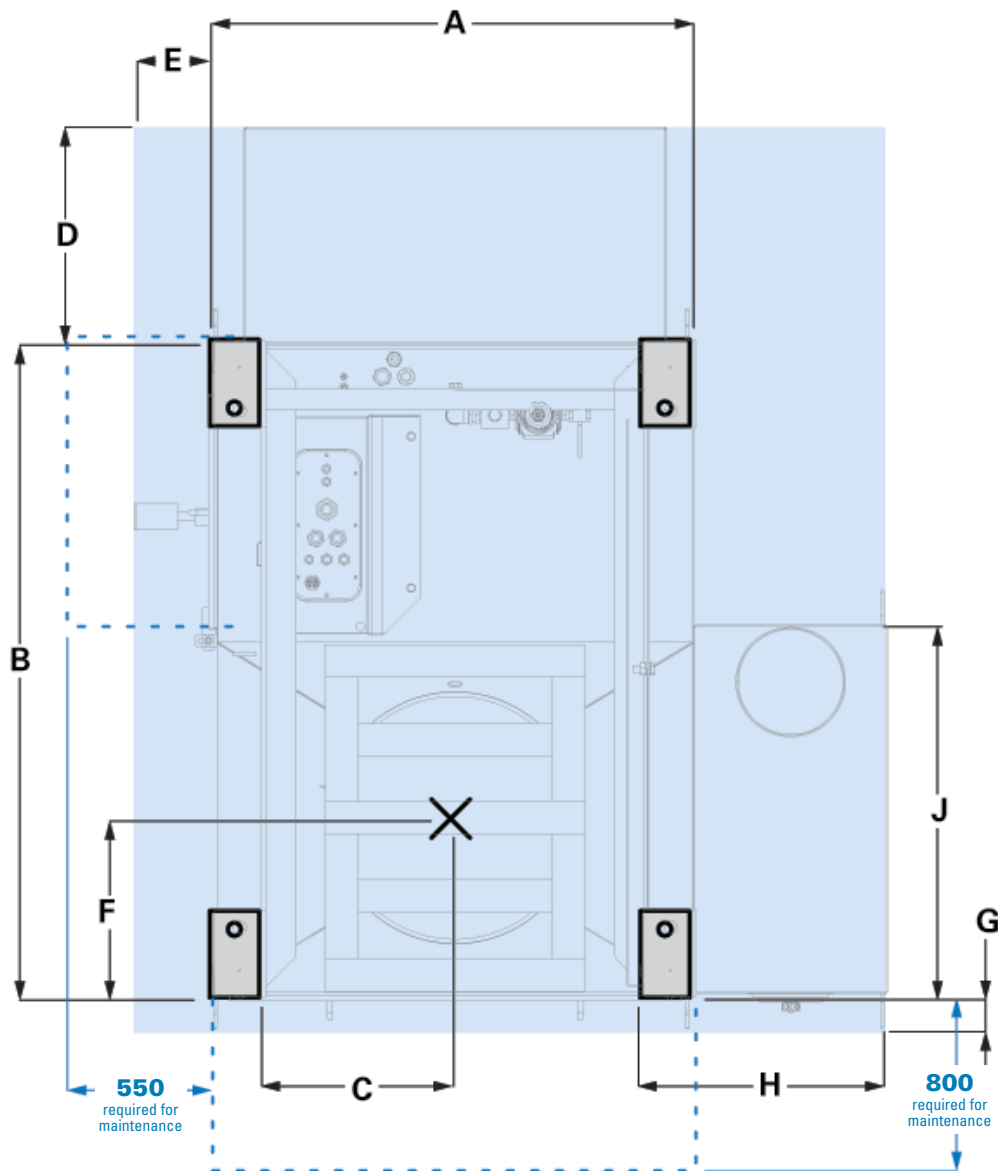
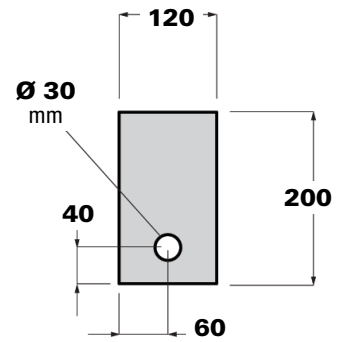
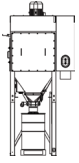

4L - Sparktrap - Partially integrated fan dimensions (in mm)								
A	B	C	D	E	F	G	H	J
1114	1513	437	493	58	412.8	73	443	844

FOUNDATION DETAILS - 4L - CYCLOPEEL - ROOF MOUNTED FAN

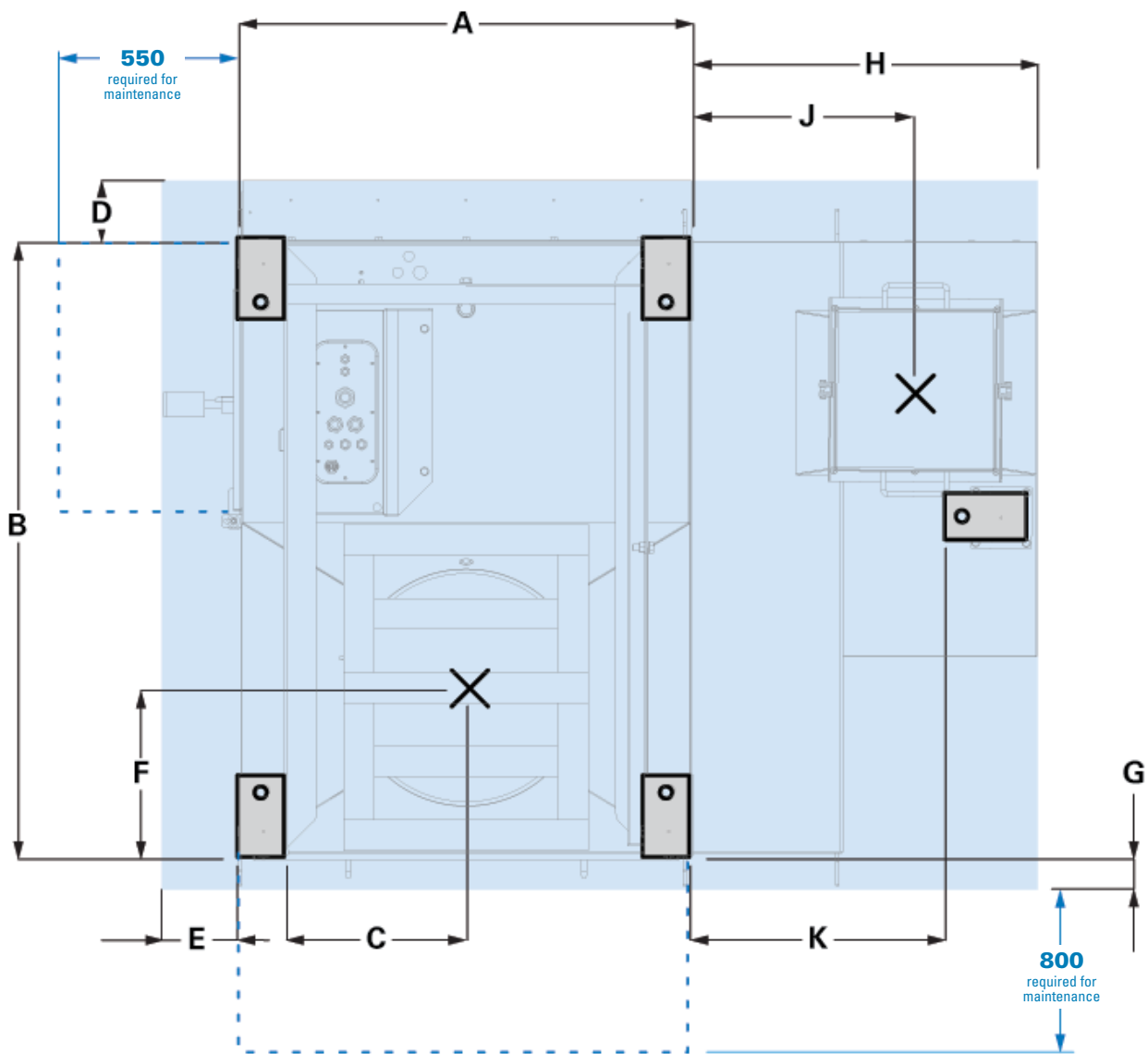
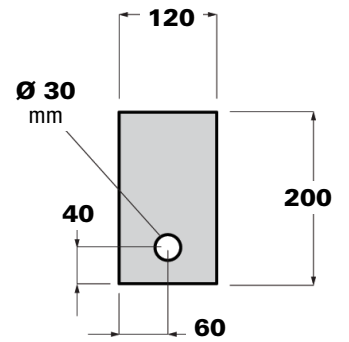
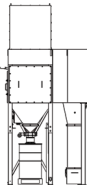

4L - Cyclopeel - Roof mounted fan dimensions (in mm)									
A	B	C	D	E	F	G	H	J	K
1114	1513	437	143.5	58	412.8	73	818.3	752.5	1048

FOUNDATION DETAILS - 4L - CYCLOPEEL - PARTIALLY INTEGRATED FAN

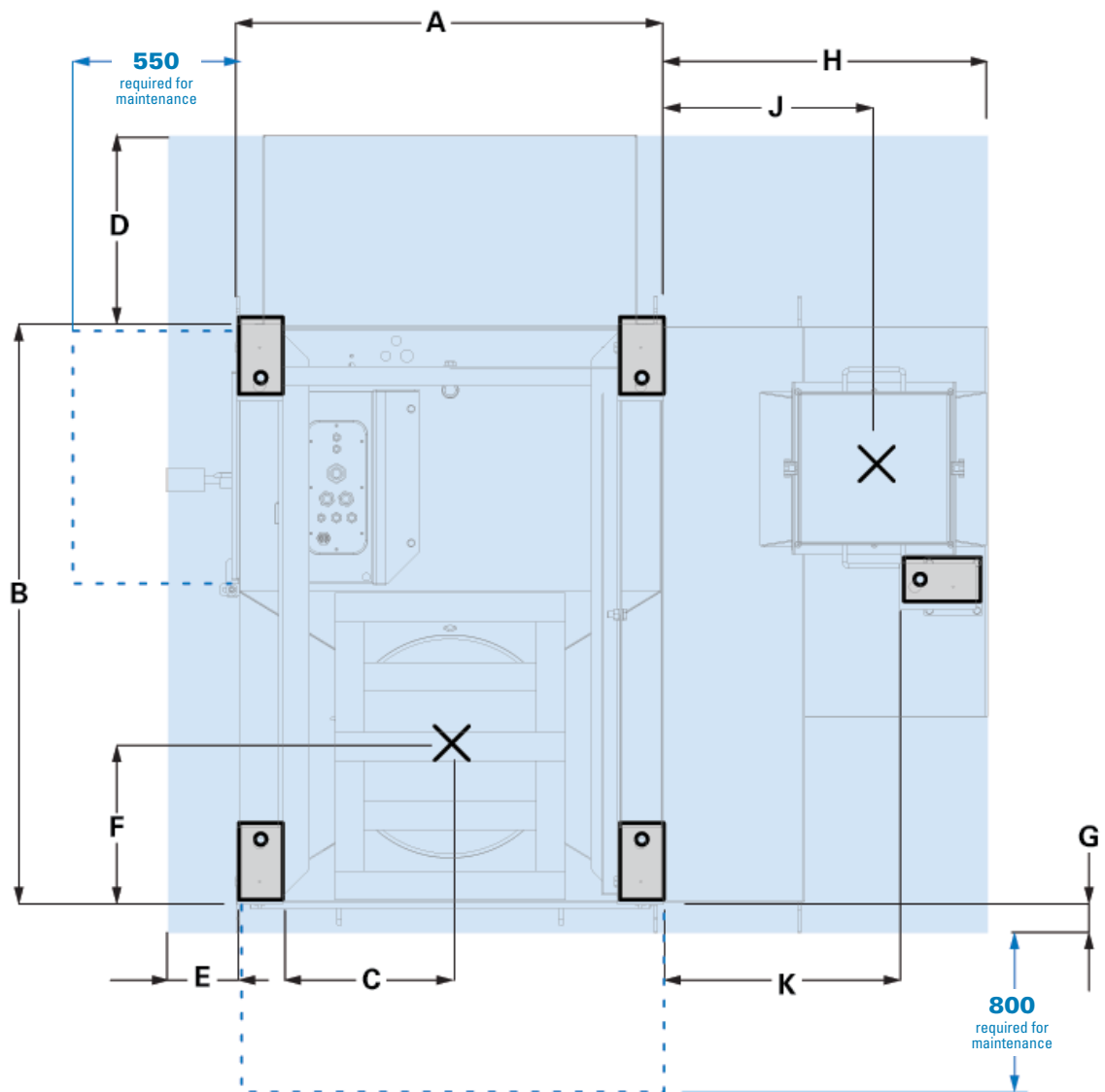
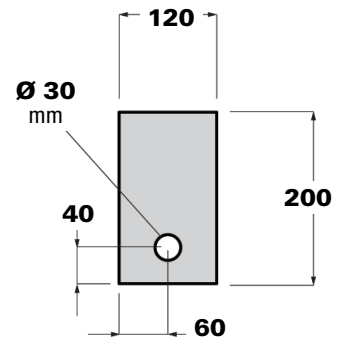
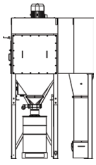

4L - Cyclopeel - Partially integrated fan dimensions (in mm)									
A	B	C	D	E	F	G	H	J	K
1114	1513	437	493	58	412.8	73	818.3	752.5	1048

FOUNDATION DETAILS - 6L - SPARKTRAP - ROOF MOUNTED FAN

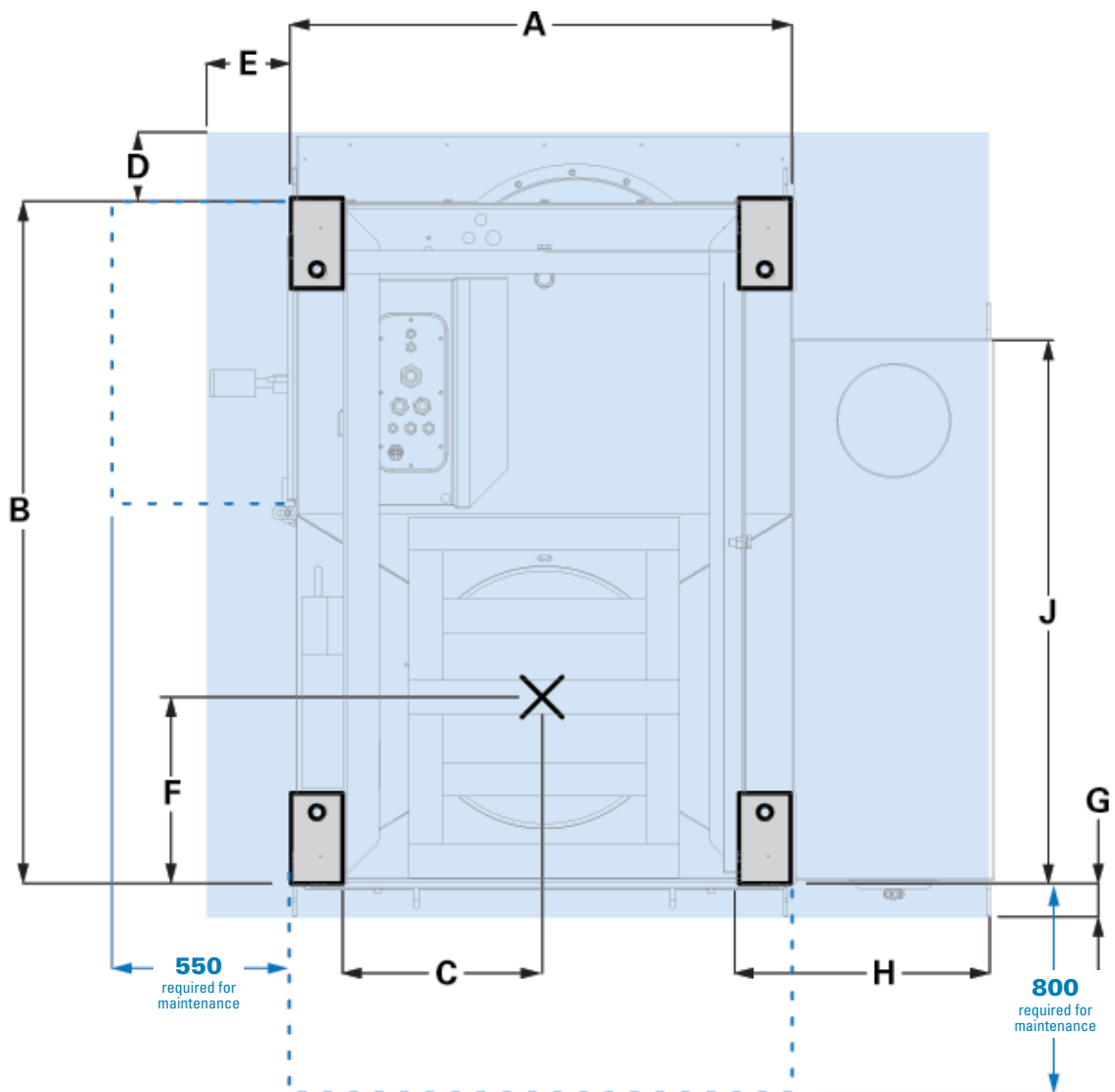
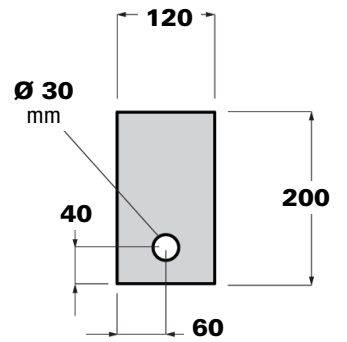
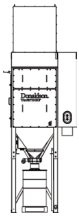

6L - Sparktrap - Roof mounted fan dimensions (in mm)								
A	B	C	D	E	F	G	H	J
1114	1513	437	143.5	58	412.8	73	443	1194

FOUNDATION DETAILS - 6L - SPARKTRAP - PARTIALLY INTEGRATED FAN

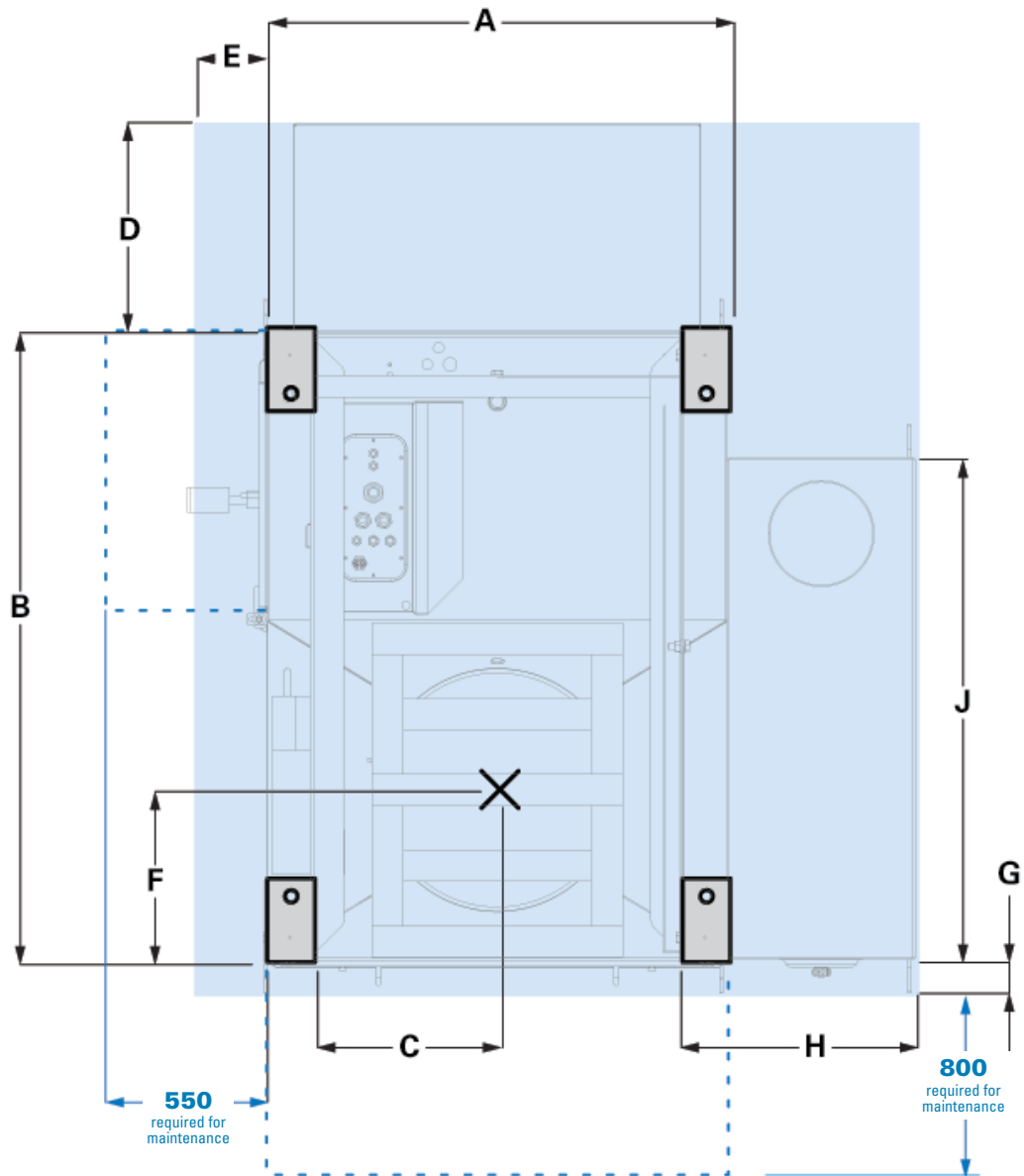
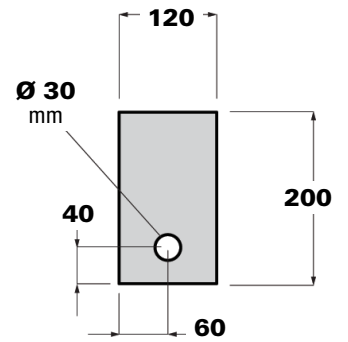
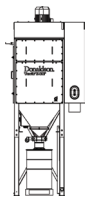

6L - Sparktrap - Partially integrated fan dimensions (in mm)								
A	B	C	D	E	F	G	H	J
1114	1513	437	493	58	412.8	73	443	1194

FOUNDATION DETAILS - 6L - CYCLOPEEL - ROOF MOUNTED FAN

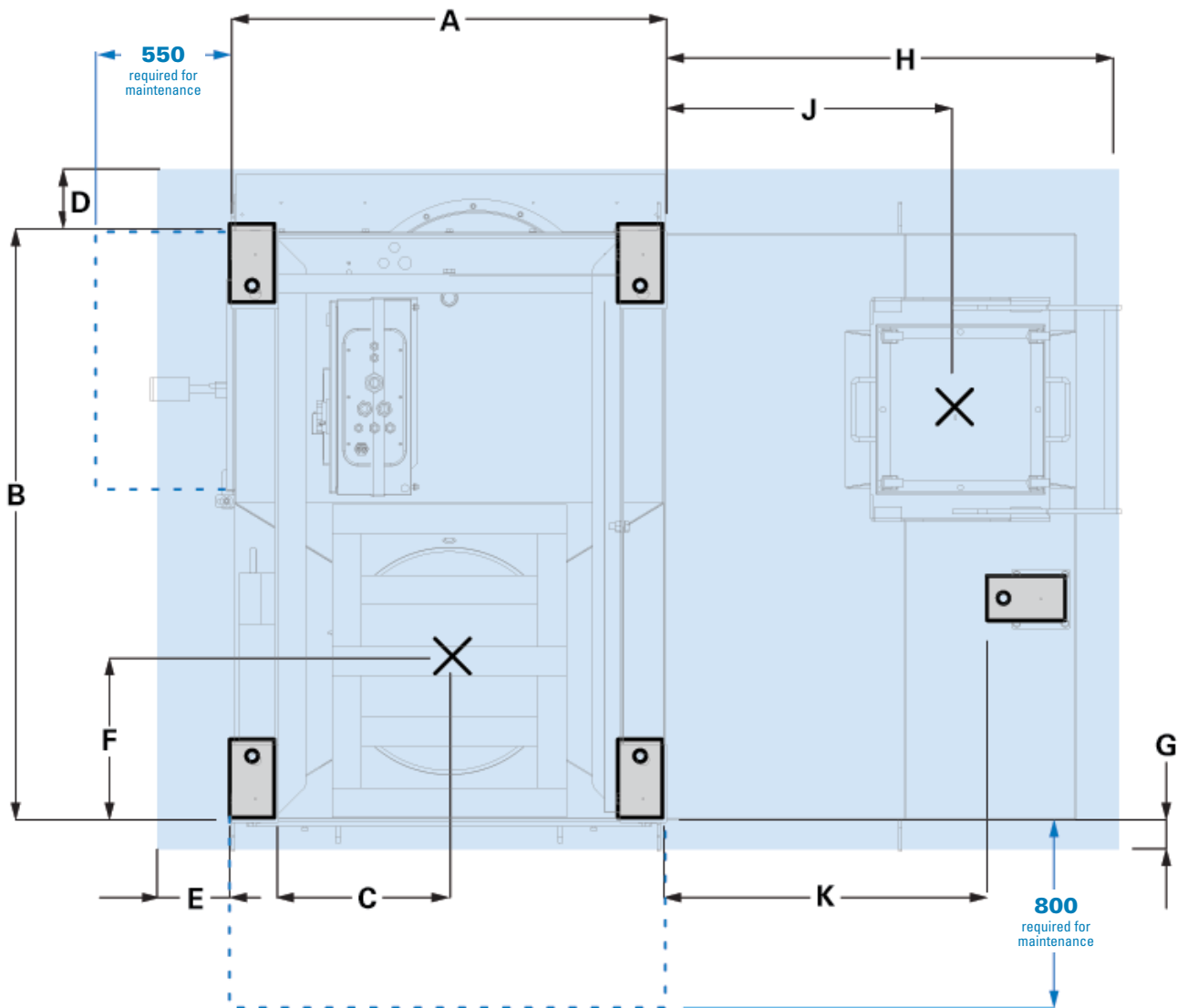
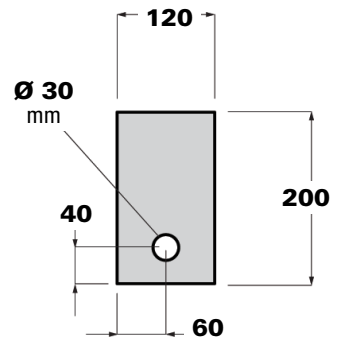
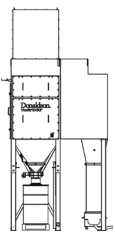

6L - Cyclopeel - Roof mounted fan dimensions (in mm)									
A	B	C	D	E	F	G	H	J	K
1114	1513	437	143.5	58	412.8	73	818.3	752.5	1048

FOUNDATION DETAILS - 6L - CYCLOPEEL - PARTIALLY INTEGRATED FAN

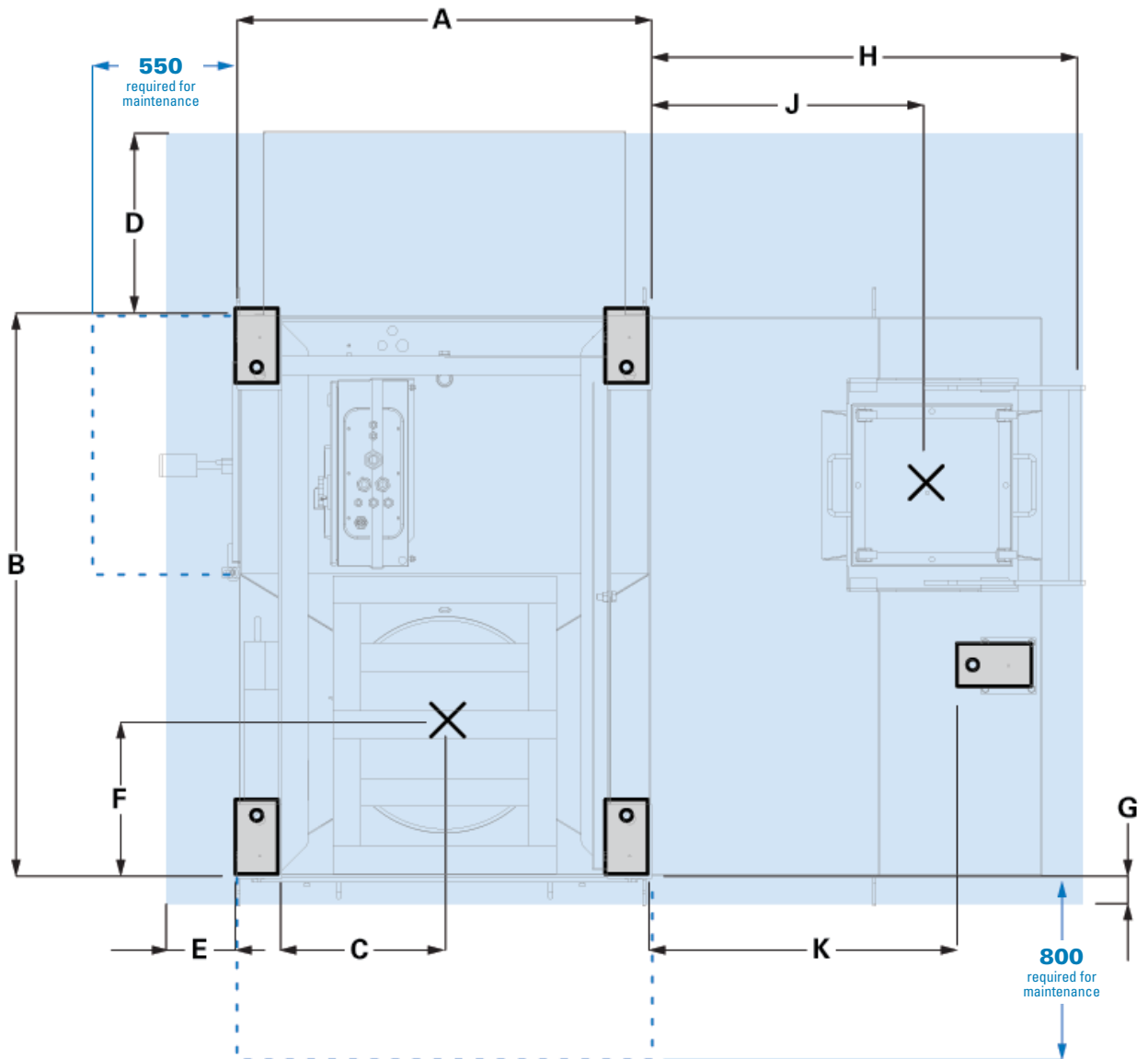
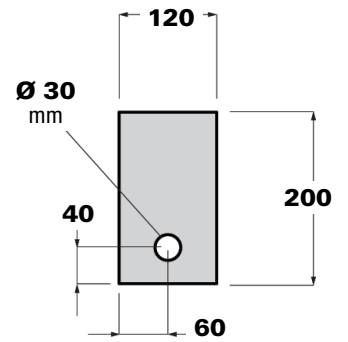
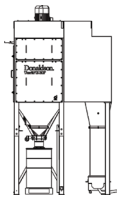

6L - Cyclopeel - Partially integrated fan dimensions (in mm)									
A	B	C	D	E	F	G	H	J	K
1114	1513	437	493	58	412.8	73	818.3	752.5	1048

ELECTRICAL REQUIREMENTS

Fully automatic cleaning mechanism:	C-Powerbox
Pulse interval time:	12 s
Control box protection class:	IP65
Input voltage:	400 V Δ 50 Hz

NOISE EMISSION

Noise emission declaration of the DFPRE 6L, measured according to EN-ISO 11201: 2010, running at maximum fan speed and 5 pulses per minute at 6 Bar with noise insulation foam:

The A-weighted emission sound pressure level re. 20 µPa	76 dB
associated total uncertainty K_{pA}	2.5 dB

The declaration is in conformance with ISO 4871.

MANIFOLD DESIGN DETAILS

Design pressure:	8 bar
Maximum operating pressure, PS:	7 bar (101.5 psig)
Test pressure:	11.5 bar
Design temperature:	-20° to +70°C
Manifold volume:	DFPRE 4L: 7 liters DFPRE 6L: 9 liters
Product of pressure and capacity:	DFPRE 4L: 49 bar liters DFPRE 6L: 63 bar liters
Material used for manifold construction:	Structural hollow section according to EN13445

COMPRESSED AIR REQUIREMENTS

Max. 7 bar	
Pressure range 6-7 bar	
Clean air (max. particle size 50 µm)	
Free of condensate at working temperature	
Max. oil content:	3 mg/m ³
Approximate compressed air usage*:	±45 litres per pulse (± 13.5 Nm ³ /h for 12 s pulse interval at 7 bar)

* The indicated value is the consumption per valve

STANDARD FEATURES & AVAILABLE OPTIONS

Unit options

Execution for outside installation
Variable hopper clearance
Full range of dust disposal systems
Compressed air – oil/water separator and accessories
Full range of fan sets
CAP insulation foam
Full range of filter cartridges
Bin balance pipe kit
DFS Feeder for the absorption of oily substances

Cartridge options

Filter assembly DFE 660mm Ultra-Web®
Filter assembly DFE 660mm Ultra-Web® Earthed
Filter assembly DFE 660mm Ultra-Web® Flame Retardant
Filter assembly DFE 660mm Ultra-Web® Flame Retardant Earthed
Filter assembly DFE 660mm Ultra-Web® on SpunBond
Filter assembly DFE 660mm Ultra-Web® on SpunBond Earthed
Filter assembly DFE 660mm Ultra-Web® on SpunBond Anti-Static
Filter assembly DFE 660mm Ultra-Web® Anti-Static
Filter assembly DFE 660mm Torit-Tex®
Filter assembly DFE 660mm Torit-Tex® Earthed
Filter assembly DFE 660mm Torit-Tex® Anti-Static
Filter assembly DFE 660mm Ultra-Web® No Liner
Filter assembly DFE 660mm Ultra-Web® Flame Retardant No Liner
Filter assembly DFE 660mm Ultra-Web® Stainless Steel
Filter assembly DFE 660mm Fibra-Web®
Filter assembly DFE 660mm Fibra-Web® Earthed
Filter assembly DFE 660mm Fibra-Web® Flame Retardant
Filter assembly DFE 660mm Thermo-Web®
Filter assembly DFE 660mm Thermo-Web® Earthed
Filter assembly DFE 660mm Kevlar Nomex (high temp)

Africa	<p>Donaldson Europe B.V.B.A. Industrial Filtration Solutions Research Parc Bldg No. 1303 Interleuvenlaan, 1 B-3001 Leuven</p> <p>Belgium IAF-africa@donaldson.com +32 16 38 39 70</p>	Netherlands	<p>Donaldson Nederland B.V. Transistorstraat 44 III NL-1322 CG Almere</p> <p>Nederland IAF-nl@donaldson.com +31 36 548 08 40</p>
Austria	<p>Donaldson Filtration Österreich GmbH Gutheil-Schoder Gasse 8-12 A-1100 Wien</p> <p>Österreich IAF-at@donaldson.com +43 16 16 52 91</p>	Norway	<p>Donaldson Filtration Norway AS Postboks 196 N-1501 Moss</p> <p>Norge IAF-no@donaldson.com +47 69 21 53 00</p>
Belgium	<p>Donaldson Europe B.V.B.A. Industrial Filtration Solutions Research Parc Bldg No. 1303 Interleuvenlaan, 1 B-3001 Leuven</p> <p>België IAF-be@donaldson.com +32 16 38 39 70</p>	Poland	<p>Donaldson Polska Sp. z o. ul. Sienna 64 PL-00-825 Warszawa</p> <p>Polska IAF-pl@donaldson.com +48 22 517 15 00</p>
Czech Republic	<p>Donaldson Filtration CR - koncern s.r.o. Konevova 139 CZ-130 83 Praha 3</p> <p>Ceská republika IAF-cz@donaldson.com +420 2 67 108 242</p>	Russia	<p>Predstavitelstvo AOOO Donaldson Nederland B.V. Centr Meždunarodnoj Torgovli Ofis 1004V, Krasnopresnenskaja nab.12 123610 Moskva</p> <p>Russia IAF-ru@donaldson.com +7 499 136 00 13</p>
Denmark	<p>Donaldson Scandinavia ApS Lyngsø Allé 3A DK - 2970 Hørsholm</p> <p>Danmark IAF-dk@donaldson.com +45 45 57 00 77</p>	Slovakia	<p>Donaldson Filtration Slovensko s.r.o. Púchovská 8 SK-83106 Bratislava 35</p> <p>Slovensko IAF-sk@donaldson.com +421 2 44872619</p>
Finland	<p>Donaldson Scandinavia ApS Lyngsø Allé 3A DK - 2970 Hørsholm</p> <p>Danmark IAF-fi@donaldson.com +45 45 57 00 77</p>	Spain	<p>Donaldson Ibérica, Soluciones en Filtración, S.L. Colom, 391 - 3ªA E-08223 Terrassa</p> <p>España IAF-es@donaldson.com +34 93 784 38 34</p>
France	<p>Donaldson France s.a.s. 33 Rue des Vanesses Zac Paris Nord II B.P. 51292 Villepinte F-95958 Roissy Charles de Gaulle Cedex</p> <p>France IAF-fr@donaldson.com +33 1 49 38 99 30</p>	Sweden	<p>Donaldson Scandinavia Industrigatan 68 S-261 35 Landskrona</p> <p>Sverige IAF-se@donaldson.com +46 418 457 550</p>
Germany	<p>Donaldson Filtration Deutschland GmbH Industriestraße 11 D-48249 Dülmen</p> <p>Deutschland IAF-de@donaldson.com + 49 2594 781-41</p>	Switzerland	<p>Donaldson Schweiz GmbH Bruggacherstrasse 18 CH-8117 Fällanden</p> <p>Schweiz IAF-ch@donaldson.com +41 (0)44 302 07 15</p>
Hungary	<p>Donaldson Filtration Magyarország Kft. Záhony u. 7. H-1031 Budapest</p> <p>Magyarország IAF-hu@donaldson.com +36 1 453 28 65/66</p>	Turkey	<p>Donaldson Filtre Sist. Tic. Ltd. Sti. Barbaros Mahallesi Palladium Tower No:2 Kat:10 34746 Ataşehir / Istanbul</p> <p>Türkiye IAF-tr@donaldson.com +90 216 687 03 26</p>
Ireland	<p>Donaldson Filtration (GB) Ltd. Suite 31, The Hyde Building The Park Carrickmines, Dublin 18</p> <p>Ireland IAF-ie@donaldson.com +353 1 525 22 49</p>	United Kingdom	<p>Donaldson Filtration (GB) Ltd. Humberstone Lane Thurmaston Leicester LE4 8HP</p> <p>United Kingdom IAF-uk@donaldson.com +44 116 269 6161</p>
Italy	<p>Donaldson Italia S.r.l. Via Cesare Pavese, 5/7 20090 Opera (Milan)</p> <p>Italia IAF-it@donaldson.com +39 0 25 30 05 21</p>	Other countries	<p>Donaldson Filtration (GB) Ltd. Humberstone Lane Thurmaston Leicester LE4 8HP</p> <p>United Kingdom IAF-export@donaldson.com +44 116 269 6161</p>
Middle East	<p>Donaldson Europe B.V.B.A. Office 1905 Jebel Ali Free Zone Dubai</p> <p>United Arab Emirates IAF-middle-east@donaldson.com +971 4 885 5311</p>		

Learn more



Donaldson.com