



Donaldson
FILTRATION SOLUTIONS

**POWERCORE® SVU SERIES
SMALLER. SMARTER
SILO VENTING FILTERS**



PowerCore
A Donaldson Filtration Technology

SMALLER. SMARTER SILO VENTING FILTERS



The compact SVU series brings the performance and convenience of the PowerCore® technology to the silo venting market.

Built to withstand severe weather conditions, the **SVU series** is specially designed for use on pneumatically filled storage silos with airflows up to 2000 m³/hr.

The **PowerCore SVU Series** will satisfy the need not only for efficiency and reduced maintenance, but also for convenience and workers' safety.

You can't always avoid having your maintenance workers climbing and working on high height silos, but you can control how convenient and safe it is.

The SVU's compact and low design provides easy and safe access to the filter packs.

With the **Silo Venting Unit**, you can save space, reduce maintenance requirements and hazards generated by changing long and dirty filter bags or cartridges on a silo top. Thanks to the **PowerCore** technology, while up to 6 filter bags or cartridges have to be moved up and down on conventional silo venting solutions, the SVU only needs 2 compact and lightweight filter packs; Changing the **PowerCore** filter packs can be done easily and safely by just one person with no tools or losable part, in no time.

Time-consuming and often very dirty maintenance processes, frequently under precarious working conditions, are a thing of the past when using the **PowerCore SVU Series**.

UP TO **54%**
SHORTER THAN
TRADITIONAL SILO
VENTING COLLECTORS

Difference between **Donaldson® PowerCore® SVU Series** and a traditional silo venting collector using filter bags or cartridges.

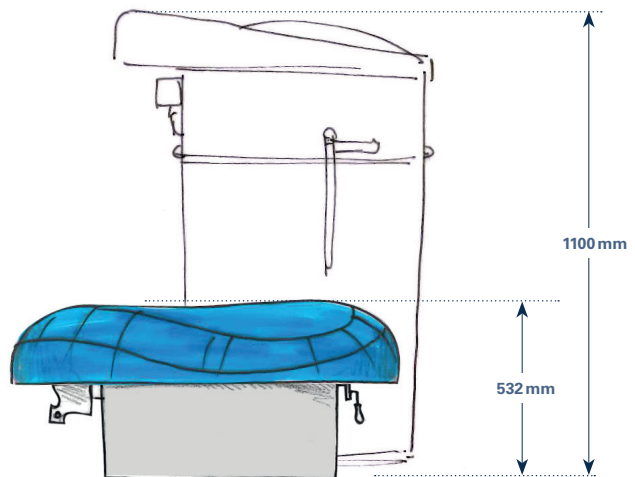

Unlike traditional silo venting solutions, the **PowerCore SVU** cover remain safely accessible.

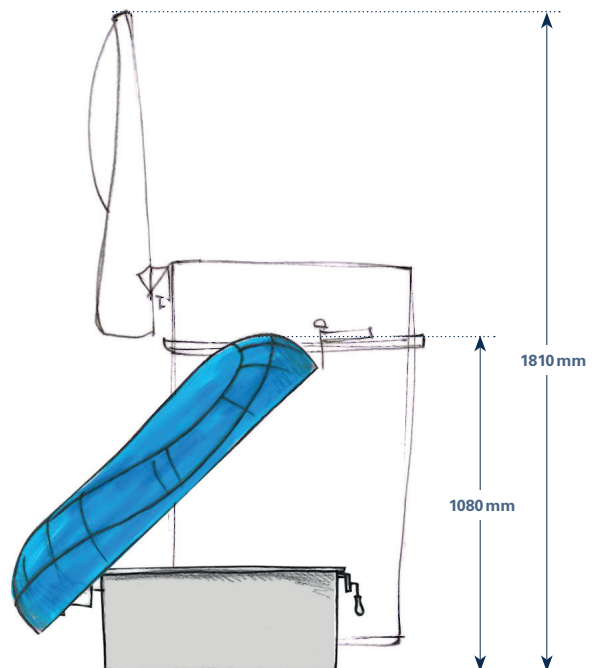

At the core of the SVU unique design is PowerCore the most innovative filtration technology from Donaldson is integral to the dramatic downsizing of the PowerCore SVU series.

An entirely new approach to dust collectors, the **PowerCore** filter pack is small, lightweight, and easily handled by one person.

Donaldson's PowerCore technology combined to our well-proven Ultra-Web advanced nanofiber technology allows more effective filter area to be packaged in a smaller space:

Pneumatic Silo Venting applications typically requiring up to 6 filter bags (24 m²) in the past now only needs 2 **PowerCore** compact filter packs. With more media packed into a smaller space and a simplified airflow path, **PowerCore** filter packs provide high performance with a low pressure drop.

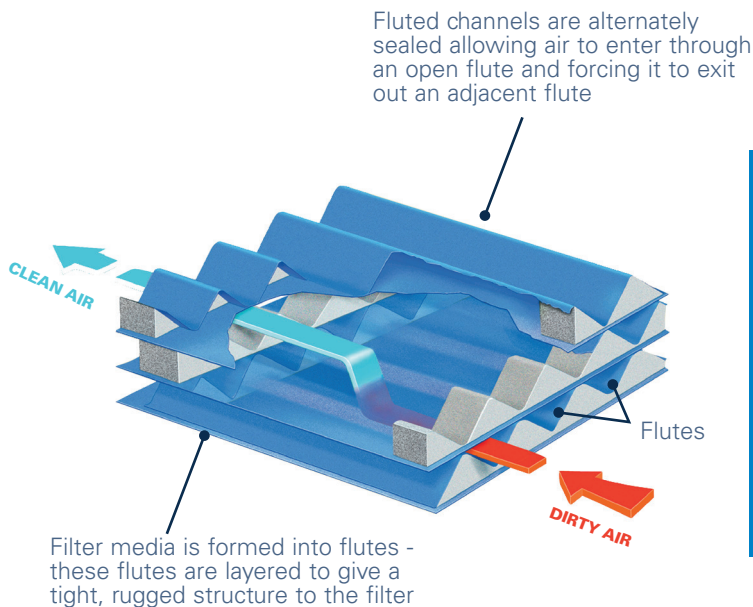

PowerCore® SVU Series

- High performance in a smaller package
- Extended maintenance intervals
- Fast, safe & easy maintenance
- Lower shipping, installation and maintenance costs
- Technology proven in field applications for more than 10 years

One **Donaldson PowerCore** filter pack, replaces up to six filter bags or cartridges.



POWERED BY
POWERCORE®
ADVANCED
FILTRATION
TECHNOLOGY

CHANGING EXPECTATIONS

The performance, reliability, and ergonomics of the SVU is derived from a combination of advanced filtration technology, unique form factors and high performance reverse jet cleaning to ensure effective dust release and a continuous level of operation for longer. Fewer filters, better cleaning, and shorter maintenance leads to major cost savings over the life of the collector.

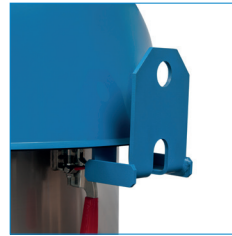

Easy installation

- Fully assembled
- Removable lifting hooks
- Pre set controller
- Mounting Flange DN800mm



Effective Filter Cleaning

- Reverse pulse jet cleaning
- Effective dust dislodging
- No filters bridging risks



Designed with safety in mind

- Compact, low height design for easy and safe filter access and maintenance.
- **Up to 54% shorter** than conventional venting units (532 mm)
- Safe cover operations due to its low height

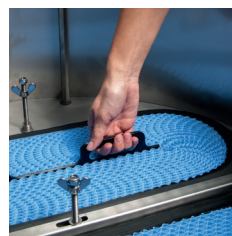

Fast & Convenient Maintenance

- Low profile for easy access
- Top-removal filters packs
- No tools required
- Hood fitted with twin gas struts for easy open and close



Robust and weather proof

- Robust Stainless Steel Body
- Controller, diaphragm valves, and pressure switch are safely protected under the weather hood
- Integrated mounting Flange

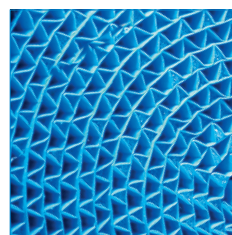

PowerCore® with Ultra-Web® technology

- High efficiency (**78% fewer emissions**)
- Long filter life
- Enhanced filtration performance
2 PowerCore® CP packs replace up to 6 traditional bags or cartridges

*Independent lab results obtained using ASTM D6830-02 per EPA PM 2.5 performance verification. Compared to Standard Polyester Bags. Annual emissions calculated assuming 26.461 m³/h (14,400 cfm) airflow rate, 265 working days per year, and two shifts per day. Field measurements may vary due to differences in dust contaminant and sensitivity of measurement equipment.

SPECIFICATIONS

CASING	
Max. height above silo	When closed: 532 mm When open: 1,080 mm
Plan	1,150 mm x 935 mm
Mounting Flange	DN 800 mm
Weight	65 kg
Design Pressure	± 5,000Pa
Colour	Cover: Blue Body: Stainless Steel
Outdoor, weather protection	UV protection
Dirty side contact parts	Stainless steel
Construction	Welded and bolted assembly

CLEANING SYSTEM	
Type	Reverse pulse jet
Compressed air pressure	6 bar (max)
Compressed air consumption	22 NI per pulse
Compressed air quality	Class 3 (ISO 8573-1)
Integrated controller	STR2 – Cycle timer
Input voltage	230/115VAC – 24VDC
PERFORMANCE SPECIFICATION	
Nominal airflow	2,000 m ³ /hr
Emission level	<5 mg/m ³
Noise Level	<80 dB(A) (ISO 3744)
Temperature specification	-10° to + 60°C



FILTERS ELEMENTS	
Filters elements	PowerCore® CP
Number of elements	2
Filter pack dimensions	L 569 x W 193 x H 178 mm

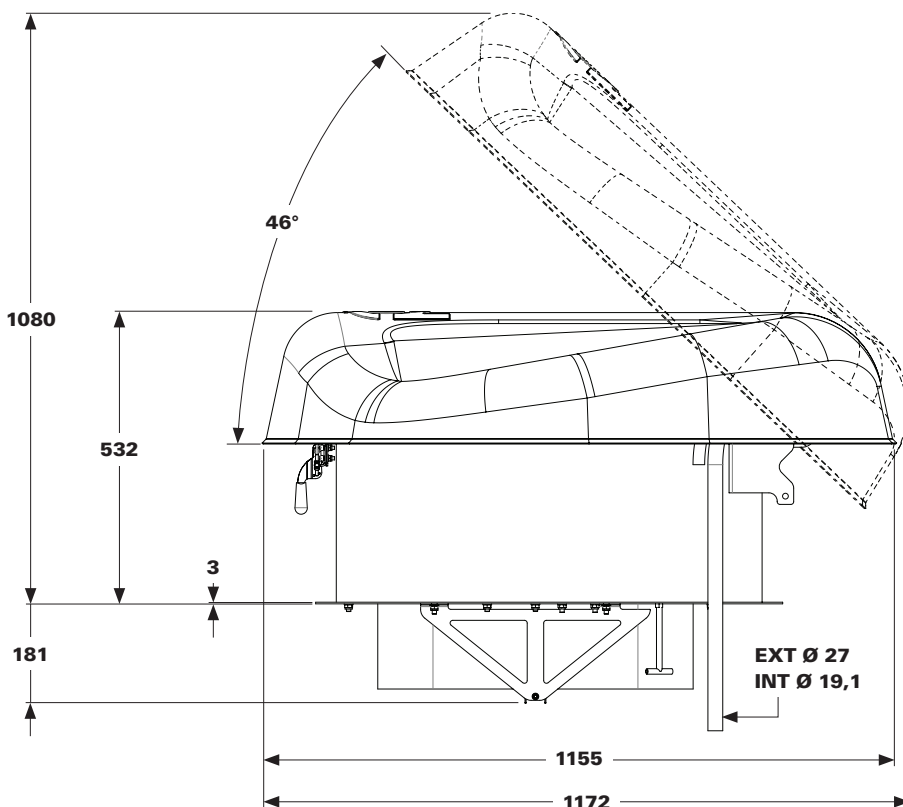
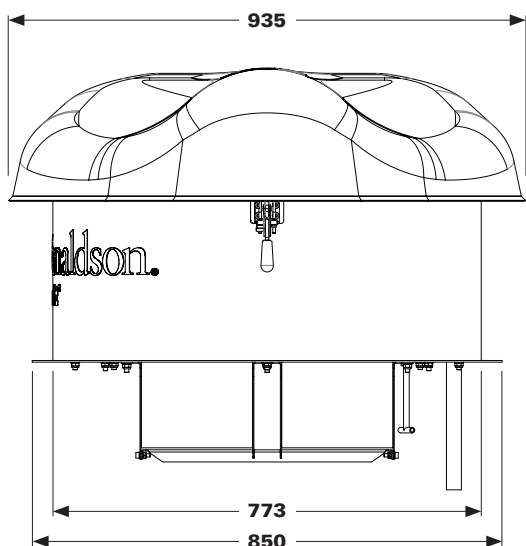

PRODUCT	DESCRIPTION	PART-NUMBER
Silo Venting Unit	Silo Venting Unit (SVU) + 2 PowerCore® CP UWSB filter packs	FAAM04945
PowerCore® CP filter packs	Ultra-Web Spunbond (UWSB) Ultra-Web Antistatic (UWAS)	2626460 P032643

Donaldson.
Torit® DCE®

Dust and Fume Removal · Oil Mist Separation



Donaldson.
FILTRATION SOLUTIONS

Total Filtration Management

Donaldson offers a wide variety of solutions to reduce your energy costs, improve your productivity, guarantee production quality and help protect the environment.

Please contact us:

Donaldson Europe B.V.B.A.
Research Park Building No. 1303
Interleuvenlaan 1 · B-3001 Leuven · Belgium
Phone +32(0)16 38 38 11 · Fax +32(0)16 40 00 77
IAF-europe@donaldson.com · www.DonaldsonToritDCE.com

Total Filtration Service

A comprehensive range of services especially designed to keep your production at peak performance and at the lowest total cost of ownership.

Donaldson Filtration (GB) Ltd.
Humberstone Lane · Thurmaston
Leicester · LE4 8HP · United Kingdom
Phone + 44 (0) 116 269 6161
IAF-uk@donaldson.com

F118016 EUK (02/17) - PowerCore SVU Series ©2017 Donaldson Europe b.v.b.a - Information in this document is subject to change without notice. - Donaldson, Torit, DCE, PowerCore, Ultra-Web are marks of Donaldson Company, Inc. All other marks belong to their respective owners